

NORROADER

AN EXCITING WAY TO EXPLORE THE SEA





NORoader IS A TRULY UNIQUE BOAT. IT HAS BEEN BUILT IN 2019 FOR A SWISS OWNER TO THE HIGHEST AVAILABLE SPECS FROM FAIRLINE. ON TOP OF THAT IT WAS IMPROVED WITH ADDITIONAL TECHNICAL INSTALLATIONS THAT ARE RARELY FOUND ON A SHIP OF THIS SIZE!

**LENGTH: 65" (20M) BUILDER: FAIRLINE MODEL: TARGA 65 GTO YEAR: 2019
TOP SPEED: 33.5KN GUESTS: 5 CABINS: 3 ASKING PRICE €2,250,000 EX TAX**



**THIS IS THE MOST CUSTOMIZED
YACHT EVER BUILDT BY FAIRLINE**

INSIDE

INTERNAL LAYOUT

All window frames of the entire boat have been replaced with dark material, creating a more spacious feeling at night and a sleek appearance during the day. The saloon and all cabins are carpeted in matching style for a cohesive look throughout.



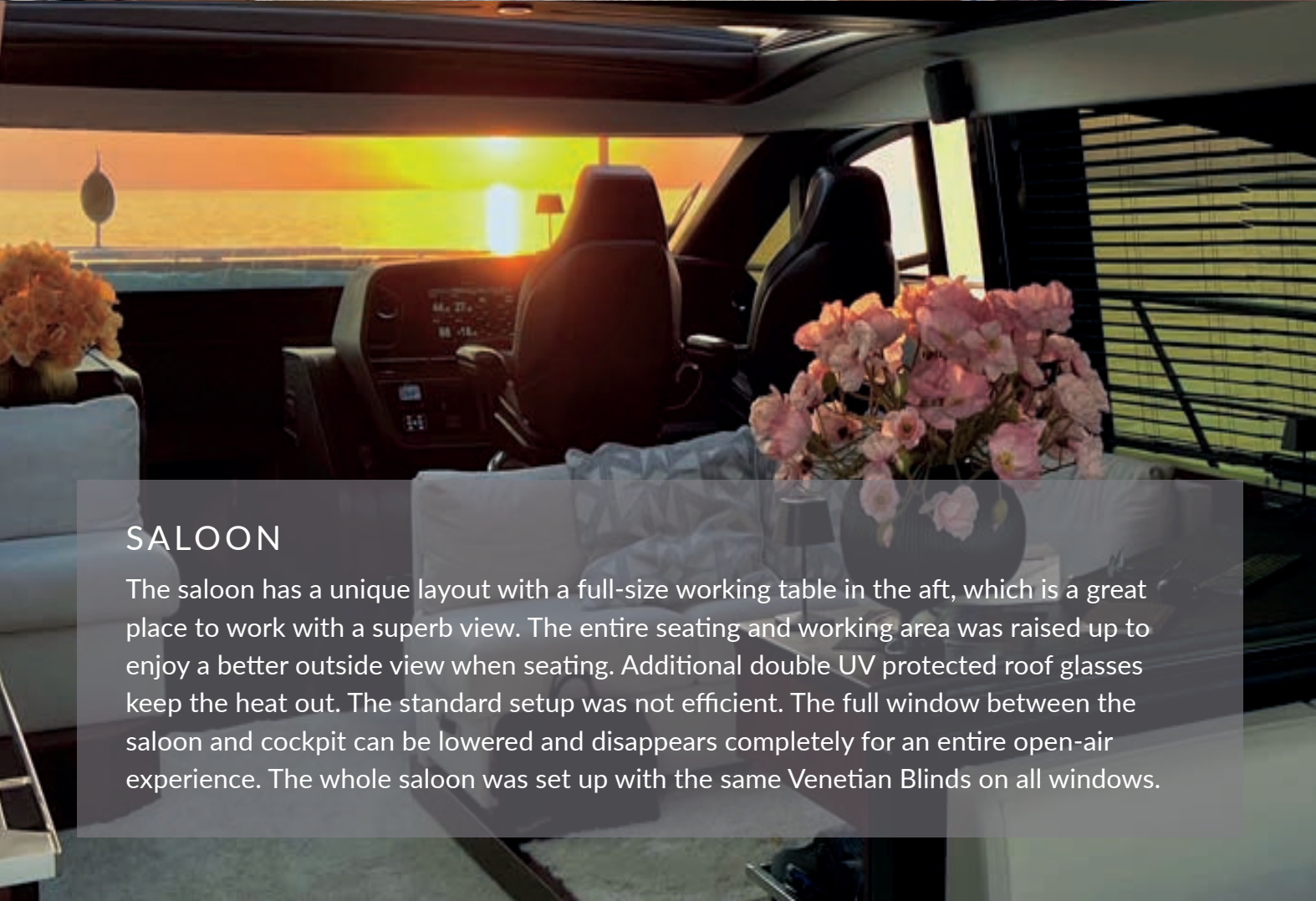

SALOON

The saloon has a unique layout with a full-size working table in the aft, which is a great place to work with a superb view. The entire seating and working area was raised up to enjoy a better outside view when seating. Additional double UV protected roof glasses keep the heat out. The standard setup was not efficient. The full window between the saloon and cockpit can be lowered and disappears completely for an entire open-air experience. The whole saloon was set up with the same Venetian Blinds on all windows.



BEDROOMS

Beside the VIP and the master bed room, the port side double bedroom has been replaced with an extended lobby and a full-size kitchen, while the bathroom with shower remained for day guests. The initially open Port Side Bunkbed Cabin was totally redone in 2023 and is now closed with one bed and storage shelves above. Ideal for a 2nd crew member or a single guest. It holds a full-size MIELE washer & dryer. The additional Fresh Air System adds a certain amount of filtered and cooled outside air to the cabins.





LOBBY AND KITCHEN

The starboard guest cabin was completely removed by the factory and there is now a spacious lobby with a kitchen.



BRIDGE

The pilot house is equipped with 3 large Raymarine plus one special Fairline control Screens. After installation of additional stainless steel pools in the front corners of the main window, a sunshade can be mounted, which allows to cruise and stay at anchor without mounting the dark mash nets. While cruising, there is significantly less heat from the sun, and at anchor, you can enjoy the full view of a beautiful bay without needing to use blackout shades.



OUTSIDE



COCKPIT

A unified ceiling stretching seamlessly from the saloon to the outside cockpit creates a stylish and integrated impression. The outside cockpit table is now full size and seats 8 persons easy, while there is a large MIELE Teppanyaki built into the customized side bar to do big steaks and more.

THE DECK

The outside area is fully covered with Esthec Teak and is easy to maintain and will keep its color.

SENSE THE OPENNESS

The windows between the saloon and the cockpit can slide completely into the floor, creating a seamless open space without any obstructions, which gives an large open living area.





TECHNOLOGY



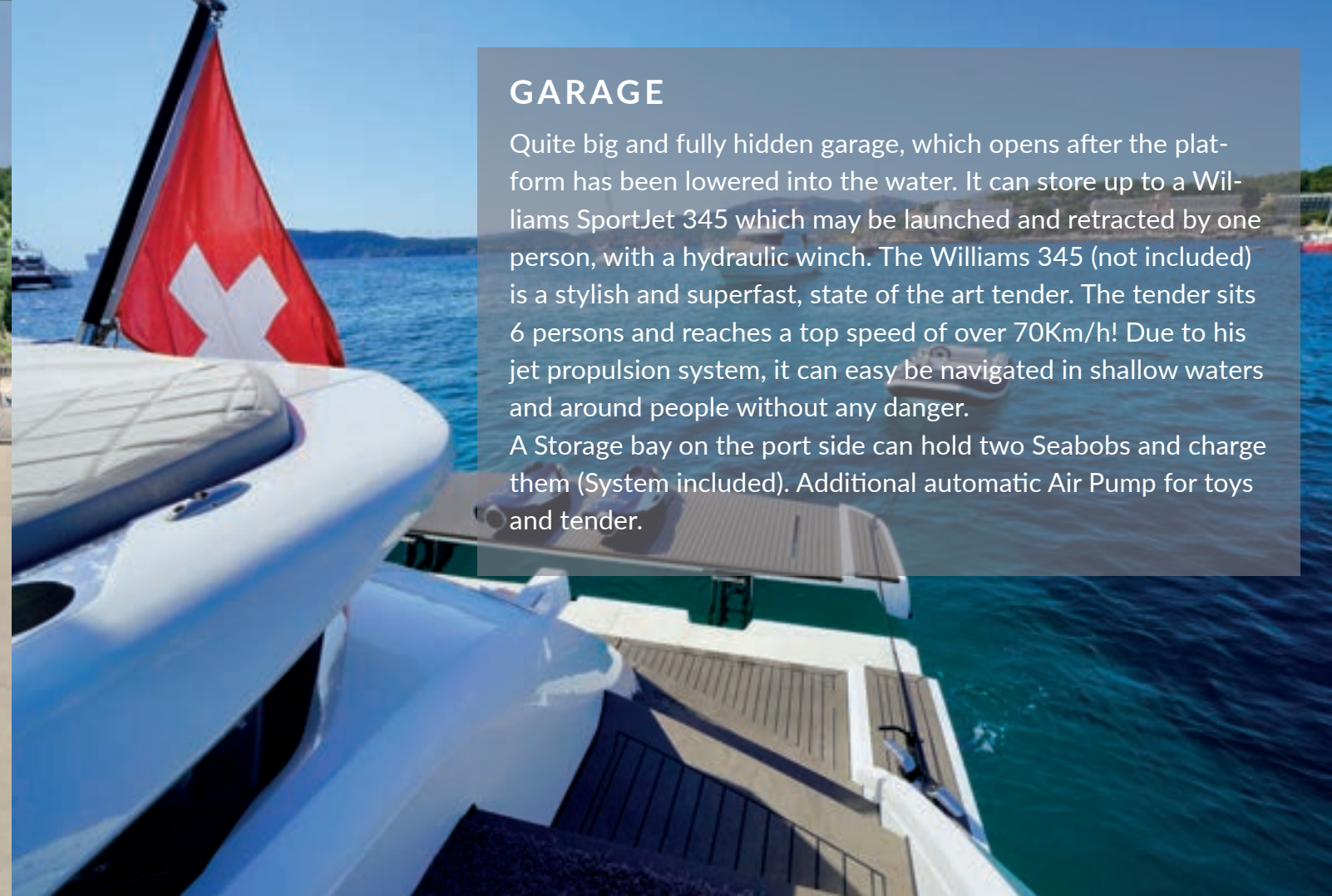

GARAGE

Quite big and fully hidden garage, which opens after the platform has been lowered into the water. It can store up to a Williams SportJet 345 which may be launched and retracted by one person, with a hydraulic winch. The Williams 345 (not included) is a stylish and superfast, state of the art tender. The tender sits 6 persons and reaches a top speed of over 70Km/h! Due to his jet propulsion system, it can easy be navigated in shallow waters and around people without any danger.

A Storage bay on the port side can hold two Seabobs and charge them (System included). Additional automatic Air Pump for toys and tender.



2 X MAN 1200 V8

The boat is equipped with two super smooth MAN 1200 V8 engines. As far as we know there are only two Fairlines on the market with these expensive engines, which can push the boat up to 33.5km with a max. consumption of 500l/h at top speed. These engines are superior in power, weight and smoothness over the standard CATERPILLAR 6 cylinder option that are mostly installed. Idle speed is 7.5kn for relaxed travelling, where the total fuel consumption is less than 10l/h, which gives a huge range! 5'000l diesel tank (2 x 2'500).

The additional trawling mode is for very smooth maneuvering (like electric) and you don't feel any prop engagement. Enter a berth with engines engaged all the time at a super slow speed while you still have the power to react fast.

TOWER

All tower equipment from the domes to the radar are done in black. There are two special super high beam remote controlled lights on the tower. The original search lights feel like candle lights compared to this powerful new ones.



GANGWAY

To easy get off the boat when docked, the “short” standard passarelle has been replaced with an extended 4.5m Besenzone version.



ANCHOR

The whole anchor setup was enforced and changed to now hold a 85Kg anchor instead of the 38kg serial one. This gives much more security, calmness and a better sleep while staying at anchor in much stronger winds!

IMPRESSIONS









ONE OF THE OWNER'S ORIGINAL INTENTIONS WAS TO EMBARK ON CHANNEL AND RIVER CRUISES THROUGHOUT EUROPE.



TECHNICAL DATA

INTERIOR

- Special UV roof protection for living room, installed in 2021
- All window bays dark, which looks nice at day and gives a much bigger feeling at night
- ▶ **The only Fairline GTO with a spacious open gallery on lower deck**
- Newly installed and now equal venetian blinds on all living room windows (no more mixed styles and materials like original)
- Specially Raised seating and working area in living room, to better enjoy the outside view.
- ▶ **Full size working desk in Saloon with big, curved-monitor.**
- 3 TV'S in two Cabins and Saloon
- Air-condition: 2 redundant compressors, with 8 chillers
- ▶ **Fresh-Air System for all cabins**
- 16 Direct USB charging points
- Preparation for an Eisenhorn Full Body Workout
- System in Lobby (Enforced Wall & Mounting points)
- ▶ **9 Sonos Zones with 20 Speakers and Subwoofer**
- MIELE Wine cooler in Saloon
- MIELE Washer & Dryer

- Full open area between cockpit and living room with no obstruction if windows are fully lowered

EXTERIOR

- ▶ **New Special High Powered twin Search lights - installed in 2021**
- All tower equipment in black
- ▶ **Sunshade for front window to not obstruct the-view while at anchor and to block the heat while cruising up to full speed**
- Side shades for covering the Cockpit from the low sun
- ▶ **Special Double size cockpit table to seat 8**
- New SILICONE Antifouling 2021
- Extra long 4.5m Besenzoni Gangway
- ▶ **Full Estec on all possible outside surfaces (no teak-treatment)**
- Outside Bar with MIELE Teppanyaki Grill, to make the big steaks and more
- ▶ Cockpit awning
- ▶ **Special made enlarged and extended sun cover top for bow area**
- Factory Enforced cockpit ceiling for installed TRX
- Workout System.

- Under Water lights (with color selector)

- ▶ **RPM noise reduction system for engine room extractors, while cooling down the engine room after cruising without disturbing the surrounding boats or people.**

EXTERIOR

- WILLIAMS Sport-Jet 345 Tender for 6 people.
- Tender can be launched and retracted by one person.
- All Hydraulic (Tender NOT INCLUDE, but available on request)
- ▶ **2 Charging and Storage Stations for SeaBobs (NOT INCLUDED)**
- Powerful built in Air Compressor for Toys and Tender

ENGINE ROOM

- 2 x MAN 1200 V8 engines (Port 680h, Stbd 676h)
- ▶ **Only two FAIRLINES with these engines are on the market.**
- Total Fuel Consumption less than 10l/h @ 7.5 knots on idle speed. Huge range!
- Trawling mode for super smooth low speed manouvering (don't feel any prop engagement)

TECHNICAL SET-UP

ANCHOR

The whole anchor setup was enforced and changed to now hold a 85Kg anchor instead of the 38kg serial one. This gives much more security, calmness and a better sleep while staying at anchor in much stronger winds!

TRIM

The original trim tabs have been replaced by HUMPHREE Interceptors for the first time on a FAIRLINE and are on some boats now as an option in the configuration. These interceptors reduced the fuel consumption, act as stabilizers while cruising, increased the top speed by 1kn, bring the bow significantly down for a much better cruising experience and view and keep the boat horizontal on speed turns, while significantly reduce the turn radius.

STABILIZATION

To stabilize the boat, there is a large and very efficient Seakeeper 16 installed. It provides the newest technology in stabilizing ships while cruising or at anchor and without any outside fins that compromise the speed and fuel consumption. The system is completely silent while operating and the oversize of the Seakeeper (Fairline offers Model 9 and 16) provides stunning results in reducing the rolling of the boat to almost zero. We have never seen such stunning results from fin only systems. The Humphree Interceptors stabilize the boat additionally while cruising.

ELECTRIC POWER

On boats of this size, even the best generators will be noticed at anchor or at night, while they are running. On client request and for the ultimate comfort to completely eliminate the noise of the ONAN 22.5 KW generator, Fairline installed for the first time a complete VICTRON Li-Ion power system with 10 x 5'000 Wh Li Fe Po 24V / 200Ah batteries. Two redundant strong Victron Quattro 8000 inverters manage the 50'000 Wh of total battery capacity, which and can run the whole boat including aircondition and seakeeper, for up to 10 hours. This provides a completely silent and emission free stay at anchor or during the whole night. Thanks to the additionally installed alternators on each main engine, batteries are recharged while cruising or alternatively automatically with the generator. We don't know any other boat of this size with such a luxurious and powerful system. Additional Alternators on each engine to charge the Lithium Ion System while cruising, to not use the generator.

ENGINES

The boat is equipped with two super smooth MAN 1200 V8 engines. As far as we know there are only two Fairlines on the market with these expensive engines, which can push the boat up to 33.5kn. These engines are superior in power, weight and smoothness over the standard CATERPILLAR 6 cylinder option that are mostly installed. Idle speed is 7.5kn for relaxed travelling, where the total fuel consump-

tion is less than 10l/h, which gives a huge range! 5'000l diesel tank (2 x 2'500l). The additional trawling mode is for very smooth maneuvering (like electric) and you don't feel any prop engagement. Enter a berth with engines engaged all the time at a super slow speed while you still have the power to react fast.

TRUSTERS

To extend the smooth and powerful operation, the boat is equipped with strong hydraulic Trusters which operate smooth from zero to 100% or an unlimited time of use and not just for a few minutes like the electric ones. The truster system is redundantly powered by two PTO hydraulic pumps that are directly attached to each main engine.

MUSIC & SOUND

SONOS System to the max in every room, bathroom and outside.

- 5 Salon Speakers and Soundbar with one Subwoofer
- 2 water proof cockpit speakers
- 2 water proof bow area speakers
- 2 Master Cabin speakers with Soundbar plus 1 Bathroom speaker
- 2 VIP Cabin Speakers with Soundbar, 1 Bathroom Speakers
- 2 Lobby / Kitchen Speakers
- 1 Guest Bathroom Speaker

COMMUNICATIONS

- Internet thru double SIM GSM router in the roof domes. Fully cabled thru the whole boat with many RJ45 sockets plus Wi-Fi routers.
- Ready for Starlink Installation
- AIS (Automatic Identification System) sends location data to satellites to avoid collision at sea and track the boat if wanted.
- VHF Radio
- EPIRP Satellite Rescue System
- 3 Wireless Duplex Crew Communication Units with headsets. No need to push any buttons you just talk.

CABIN CREW

The crew cabin (accessible from the aft) was improved over standard setup and now has a much better bed, a real not foldable mattress and provides more storage.

REMOTE CONTROLLER

To maneuver and dock the boat by one person, there is a YACHT CONTROLLER system installed which lets you remotely control both engines and both thrusters.

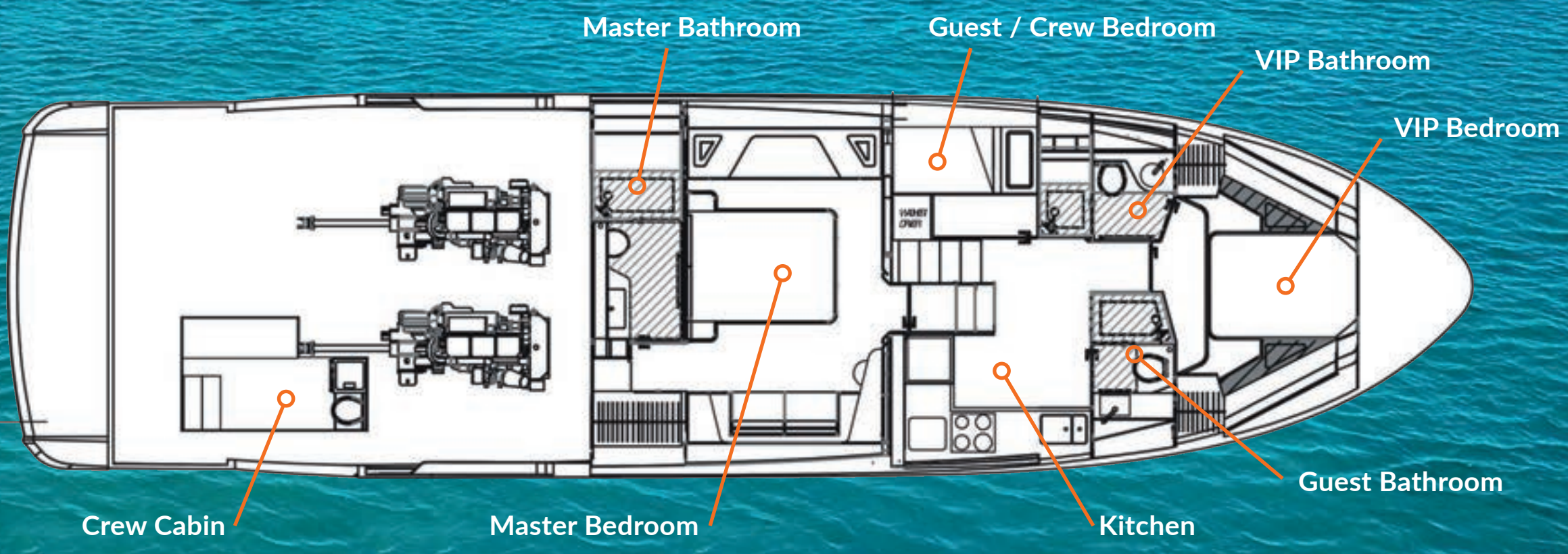
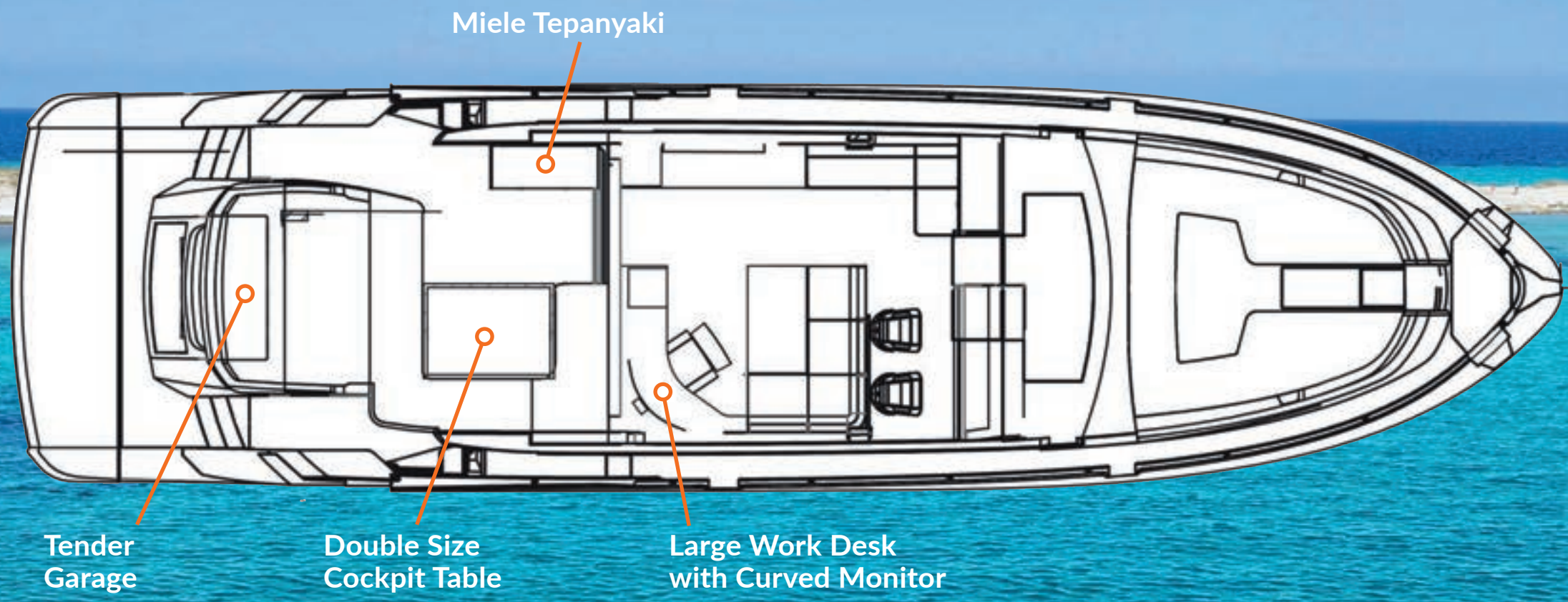

LUXURY, SAFETY AND COMFORT

In addition to the standard configuration, this boat has extras and special options with a value of over 750'000.- EUR.

Please compare with other boats.



THE NOROADER IS READY TO GO.
JUST BRING YOUR TOOTH BRUSH!



This document is not contractual. All specifications are given in good faith and offered for informational purposes only. The publisher and company do not warrant or assume any legal liability or responsibility for the accuracy, completeness, or usefulness of any information and/or images displayed. Yacht inventory, specifications and charter prices are subject to change without prior notice. None of the text and/or images used in this brochure maybe reproduced without written consent from the publisher.

WWW.NOROADER4SALE.COM

Matt Palmer T +33 6 079 37 393 matt.palmer@northropandjohnson.com